

Piston rod cylinders → Standard cylinders

Mini cylinder, ISO 6432, series MNI

► Ø 10 - 25 mm ► Ports: M5 - G 1/8 ► double-acting ► cushioning: elastic ► corrosion-protected ► with integrated rear eye ► Piston rod: external thread ► ATEX optional

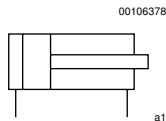

Standards	ISO 6432
Compressed air connection	internal thread
Working pressure min./max.	1 bar / 10 bar
Ambient temperature min./max.	-25 °C / +80 °C
Medium temperature min./max.	-25 °C / +80 °C
Medium	Compressed air
Max. particle size	50 µm
Oil content of compressed air	0 mg/m ³ - 5 mg/m ³
Pressure for determining piston forces	6,3 bar

Materials:	
Cylinder tube	Stainless steel
Piston rod	Stainless steel
Piston	Brass, Aluminum
Front cover	Aluminum, anodized
End cover	Aluminum, anodized
Seal	Acrylonitrile Butadiene Rubber; Polyurethane
Nut for cylinder mounting	Steel, galvanized
Nut for piston rod	Steel, galvanized
Scraper	Polyurethane

Technical Remarks

- The pressure dew point must be at least 15 °C under ambient and medium temperature and may not exceed 3 °C.
- The oil content of air pressure must remain constant during the life cycle.
- Use only the approved oils from Bosch Rexroth, see chapter „Technical information“.
- ATEX-certified cylinders are available at Bosch Rexroth sales centres
- ATEX ID: II 2G c IIB T4II 2D c IP65 T125 °C X
- The operating temperature range for ATEX-certified cylinders is -20 °C to +50 °C.

Piston Ø		[mm]	10	12	16	20	25
Retracting piston force		[N]	42	53	109	166	260
Extracting piston force		[N]	49	71	127	198	309
Weight	0 mm stroke	[kg]	0.034	0.063	0.082	0.135	0.233
	+10 mm stroke	[kg]	0.0024	0.0046	0.0055	0.009	0.013
Stroke max.		[mm]	250	600	800	1100	1300

Piston rod cylinders → Standard cylinders

Mini cylinder, ISO 6432, series MNI

► Ø 10 - 25 mm ► Ports: M5 - G 1/8 ► double-acting ► cushioning: elastic ► corrosion-protected ► with integrated rear eye ► Piston rod: external thread ► ATEX optional

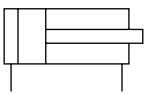
Piston Ø Piston rod thread Ports Piston rod Ø Cylinder outer thread	10	12	16	20	25	
	M4 M5 4 M12x1,25	M6 M5 6 M16x1,5	M6 M5 6 M16x1,5	M8 G 1/8 8 M22x1,5	M10x1,25 G 1/8 10 M22x1,5	
	Stroke 10	0822030201	0822031201	0822032201	0822033201	0822034201
	25	0822030202	0822031202	0822032202	0822033202	0822034202
	50	0822030203	0822031203	0822032203	0822033203	0822034203
	80	0822030204	0822031204	0822032204	0822033204	0822034204
	100	0822030205	0822031205	0822032205	0822033205	0822034205
	125	-	0822031206	0822032206	0822033206	0822034206
	160	-	0822031207	0822032207	0822033207	0822034207
	200	-	-	0822032208	0822033208	0822034208
	250	-	-	-	0822033209	0822034209
	320	-	-	-	0822033210	0822034210
	400	-	-	-	-	0822034211
	500	-	-	-	-	0822034212

other versions can be ordered from Bosch Rexroth sales offices

Dimensions

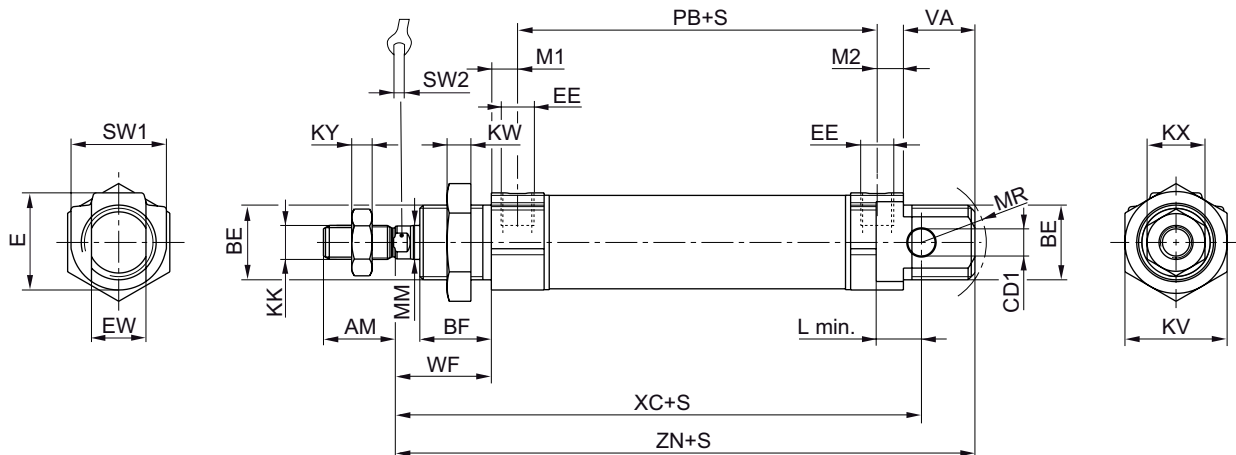

00106425_d

S = stroke

Piston Ø	AM -2	BE	BF	CD H9	E	EE	EW d13	KK	KV	KW	KX	KY
10	12	M12x1,25	11	4	14	M5 t=5	8	M4	17	5.5	7	2.2
12	16	M16x1,5	16	6	19	M5 t=5	12	M6	22	6	10	3.2
16	16	M16x1,5	16	6	19	M5 t=5	12	M6	22	6	10	3.2
20	20	M22x1,5	18	8	28	G 1/8 t=8	16	M8	30	7	13	4
25	22	M22x1,5	21	8	28	G 1/8 t=8	16	M10x1,25	30	7	17	6

Piston Ø	L min	MM f8	M1/M2	MR	PB ±1	VA	WF ±1,4	XC ±1	ZN ± 1,4	SW 1	SW 2
10	6	4	4.8	12	37	11	16	64	73.5	13	3
12	8	6	4.8	16	41	16	22	75	88.5	19	5
16	8	6	4.8	16	47	17	22	82	95.5	19	5
20	12	8	7	18	51	19	24	95	109.5	28	6
25	12	10	7	19	55	21	28	104	119.5	28	8

t = depth of thread